

品名	仕様	数量	単位	備考	
柱	C1	210x210	ASR (ASR) E105-F300		
	C2	210x210	ASR (ASR) E105-F300		
	C3	150x150	ASR (ASR) E105-F300		
	C4	120x120	ASR (ASR) E105-F300		
	C5	105x105	ASR (ASR) E105-F300		
	C6	100x100	ASR (ASR) E105-F300		
	C7	300x300	ASR (ASR) E105-F300	0418	
	C8	255x255	ASR (ASR) E105-F300	728	
	C3'	120x150	ASR (ASR) E105-F300		
	C4'	120x150	ASR (ASR) E105-F300		
	間柱	P1	120x120	ASR (YF)	
		P2	105x105	ASR (YF)	
		P3	105x105/2	ASR (YF)	0455
		P4	150x150/2	ASR (ASR) E105-F300	
		P5	150x150	ASR (ASR) E105-F300	
		P6	100x100	ASR (YF)	
P7		120x120	ASR (YF)		
P4'		90x150	ASR (ASR) E105-F300		
方柱		G1	150x300	ASR (YF) E75-F240	
		G1A	100x300	ASR (YF) E75-F240	
		G2	120x300	ASR (YF)	
		G3	120x240	ASR (YF)	
		G4	150x180	ASR (YF)	
		G5	150x270	ASR (YF) E75-F240	
		G6	150x240	ASR (YF) E75-F240	
		G7	120x100	ASR (YF) E75-F240	
	G8	150x330	ASR (YF) E75-F240		
	G2'	180x300	ASR (YF)		
	G3'	150x240	ASR (YF)		
	G4'	150x195	ASR (YF)		
	片組梁	K1	150x180	ASR (ASR) E105-F300	
		K2	150x210	ASR (ASR) E105-F300	
		K3	120x150	ASR (YF)	
		K4	105x150	ASR (YF)	
小梁	K1'	56x180	ASR (YF)		
	B11	150x270	ASR (ASR) E105-F300		
	B12	120x270	ASR (YF)		
	B13	120x180	ASR (YF)		
	B14	120x150	ASR (YF)		
	B15	105x150	ASR (YF)		
階段梁	B16	150x150	ASR (YF)		
	B17	90x150	ASR (YF)	大梁に	
	B18	60x120	ASR (YF)	大梁に	
	B19	60x180	ASR (YF)	大梁に	
梁	B20	60x120	ASR (YF)	大梁に	
	B21	60x180	ASR (YF)	大梁に	
	B22	60x120	ASR (YF)	大梁に	
土台	D1	120x120	ASR (ASR)		
	D2	90x180	ASR (ASR)		
	D3	90x120	ASR (ASR)		

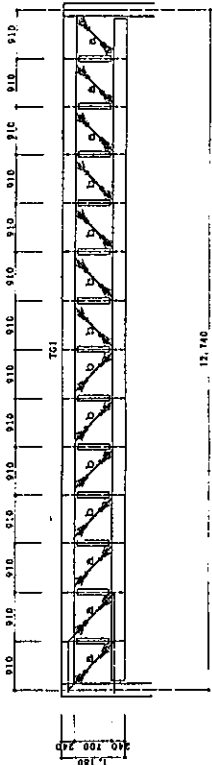

図例 (1) (2) (3) (4) (5) (6) (7) (8) (9) (10) (11) (12) (13) (14) (15) (16) (17) (18) (19) (20) (21) (22) (23) (24) (25) (26) (27) (28) (29) (30) (31) (32) (33) (34) (35) (36) (37) (38) (39) (40) (41) (42) (43) (44) (45) (46) (47) (48) (49) (50) (51) (52) (53) (54) (55) (56) (57) (58) (59) (60) (61) (62) (63) (64) (65) (66) (67) (68) (69) (70) (71) (72) (73) (74) (75) (76) (77) (78) (79) (80) (81) (82) (83) (84) (85) (86) (87) (88) (89) (90) (91) (92) (93) (94) (95) (96) (97) (98) (99) (100)

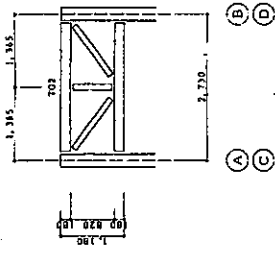

図例 (1) (2) (3) (4) (5) (6) (7) (8) (9) (10) (11) (12) (13) (14) (15) (16) (17) (18) (19) (20) (21) (22) (23) (24) (25) (26) (27) (28) (29) (30) (31) (32) (33) (34) (35) (36) (37) (38) (39) (40) (41) (42) (43) (44) (45) (46) (47) (48) (49) (50) (51) (52) (53) (54) (55) (56) (57) (58) (59) (60) (61) (62) (63) (64) (65) (66) (67) (68) (69) (70) (71) (72) (73) (74) (75) (76) (77) (78) (79) (80) (81) (82) (83) (84) (85) (86) (87) (88) (89) (90) (91) (92) (93) (94) (95) (96) (97) (98) (99) (100)

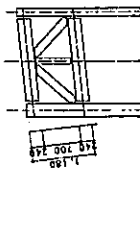

図例 (1) (2) (3) (4) (5) (6) (7) (8) (9) (10) (11) (12) (13) (14) (15) (16) (17) (18) (19) (20) (21) (22) (23) (24) (25) (26) (27) (28) (29) (30) (31) (32) (33) (34) (35) (36) (37) (38) (39) (40) (41) (42) (43) (44) (45) (46) (47) (48) (49) (50) (51) (52) (53) (54) (55) (56) (57) (58) (59) (60) (61) (62) (63) (64) (65) (66) (67) (68) (69) (70) (71) (72) (73) (74) (75) (76) (77) (78) (79) (80) (81) (82) (83) (84) (85) (86) (87) (88) (89) (90) (91) (92) (93) (94) (95) (96) (97) (98) (99) (100)

図例 (1) (2) (3) (4) (5) (6) (7) (8) (9) (10) (11) (12) (13) (14) (15) (16) (17) (18) (19) (20) (21) (22) (23) (24) (25) (26) (27) (28) (29) (30) (31) (32) (33) (34) (35) (36) (37) (38) (39) (40) (41) (42) (43) (44) (45) (46) (47) (48) (49) (50) (51) (52) (53) (54) (55) (56) (57) (58) (59) (60) (61) (62) (63) (64) (65) (66) (67) (68) (69) (70) (71) (72) (73) (74) (75) (76) (77) (78) (79) (80) (81) (82) (83) (84) (85) (86) (87) (88) (89) (90) (91) (92) (93) (94) (95) (96) (97) (98) (99) (100)

品名	仕様	数量	単位	備考
柱	ASR	100x240	ASR (ASR) E105-F300	
	ASR	180x240	ASR (ASR) E105-F300	
	ASR	120x120	ASR (YF)	
	ASR	2-1122	ASR (ASR) E105-F300	
梁	a	2-1122	ASR (ASR) E105-F300	
	b	2-1116	ASR (ASR) E105-F300	

図例 (1) (2) (3) (4) (5) (6) (7) (8) (9) (10) (11) (12) (13) (14) (15) (16) (17) (18) (19) (20) (21) (22) (23) (24) (25) (26) (27) (28) (29) (30) (31) (32) (33) (34) (35) (36) (37) (38) (39) (40) (41) (42) (43) (44) (45) (46) (47) (48) (49) (50) (51) (52) (53) (54) (55) (56) (57) (58) (59) (60) (61) (62) (63) (64) (65) (66) (67) (68) (69) (70) (71) (72) (73) (74) (75) (76) (77) (78) (79) (80) (81) (82) (83) (84) (85) (86) (87) (88) (89) (90) (91) (92) (93) (94) (95) (96) (97) (98) (99) (100)

図例 (1) (2) (3) (4) (5) (6) (7) (8) (9) (10) (11) (12) (13) (14) (15) (16) (17) (18) (19) (20) (21) (22) (23) (24) (25) (26) (27) (28) (29) (30) (31) (32) (33) (34) (35) (36) (37) (38) (39) (40) (41) (42) (43) (44) (45) (46) (47) (48) (49) (50) (51) (52) (53) (54) (55) (56) (57) (58) (59) (60) (61) (62) (63) (64) (65) (66) (67) (68) (69) (70) (71) (72) (73) (74) (75) (76) (77) (78) (79) (80) (81) (82) (83) (84) (85) (86) (87) (88) (89) (90) (91) (92) (93) (94) (95) (96) (97) (98) (99) (100)

品名	仕様	数量	単位	備考
柱	ASR	120x180	ASR (YF)	
	ASR	120x180	ASR (YF)	
	ASR	105x105	ASR (YF)	
	ASR	105x105	ASR (YF)	

図例 (1) (2) (3) (4) (5) (6) (7) (8) (9) (10) (11) (12) (13) (14) (15) (16) (17) (18) (19) (20) (21) (22) (23) (24) (25) (26) (27) (28) (29) (30) (31) (32) (33) (34) (35) (36) (37) (38) (39) (40) (41) (42) (43) (44) (45) (46) (47) (48) (49) (50) (51) (52) (53) (54) (55) (56) (57) (58) (59) (60) (61) (62) (63) (64) (65) (66) (67) (68) (69) (70) (71) (72) (73) (74) (75) (76) (77) (78) (79) (80) (81) (82) (83) (84) (85) (86) (87) (88) (89) (90) (91) (92) (93) (94) (95) (96) (97) (98) (99) (100)

品名	仕様	数量	単位	備考
柱	ASR	120x240	ASR (YF)	
	ASR	120x240	ASR (YF)	
	ASR	105x105	ASR (YF)	
	ASR	105x105	ASR (YF)	

図例 (1) (2) (3) (4) (5) (6) (7) (8) (9) (10) (11) (12) (13) (14) (15) (16) (17) (18) (19) (20) (21) (22) (23) (24) (25) (26) (27) (28) (29) (30) (31) (32) (33) (34) (35) (36) (37) (38) (39) (40) (41) (42) (43) (44) (45) (46) (47) (48) (49) (50) (51) (52) (53) (54) (55) (56) (57) (58) (59) (60) (61) (62) (63) (64) (65) (66) (67) (68) (69) (70) (71) (72) (73) (74) (75) (76) (77) (78) (79) (80) (81) (82) (83) (84) (85) (86) (87) (88) (89) (90) (91) (92) (93) (94) (95) (96) (97) (98) (99) (100)

図例 (1) (2) (3) (4) (5) (6) (7) (8) (9) (10) (11) (12) (13) (14) (15) (16) (17) (18) (19) (20) (21) (22) (23) (24) (25) (26) (27) (28) (29) (30) (31) (32) (33) (34) (35) (36) (37) (38) (39) (40) (41) (42) (43) (44) (45) (46) (47) (48) (49) (50) (51) (52) (53) (54) (55) (56) (57) (58) (59) (60) (61) (62) (63) (64) (65) (66) (67) (68) (69) (70) (71) (72) (73) (74) (75) (76) (77) (78) (79) (80) (81) (82) (83) (84) (85) (86) (87) (88) (89) (90) (91) (92) (93) (94) (95) (96) (97) (98) (99) (100)

品名	仕様	数量	単位	備考	
柱	SC1	φ-318.5x6.9	STK400		
	梁	SC1	H-350x175x11	SS400	
		SC2	H-350x175x11	SS400	
		SC3	H-350x175x11	SS400	
		SC4	H-350x175x11	SS400	
	梁	SB1	2C-180x75x10.5	SS400	
		SB2	BH-488x300x9x16	SS400	
		SB3	BH-350-488x300x9x16	SS400	
		SB4	H-250x125x6x9	SS400	
	梁	SC	φ-100x50x20x2.3φ303	SS400	
		SC	φ-100x50x20x2.3φ303	SS400	

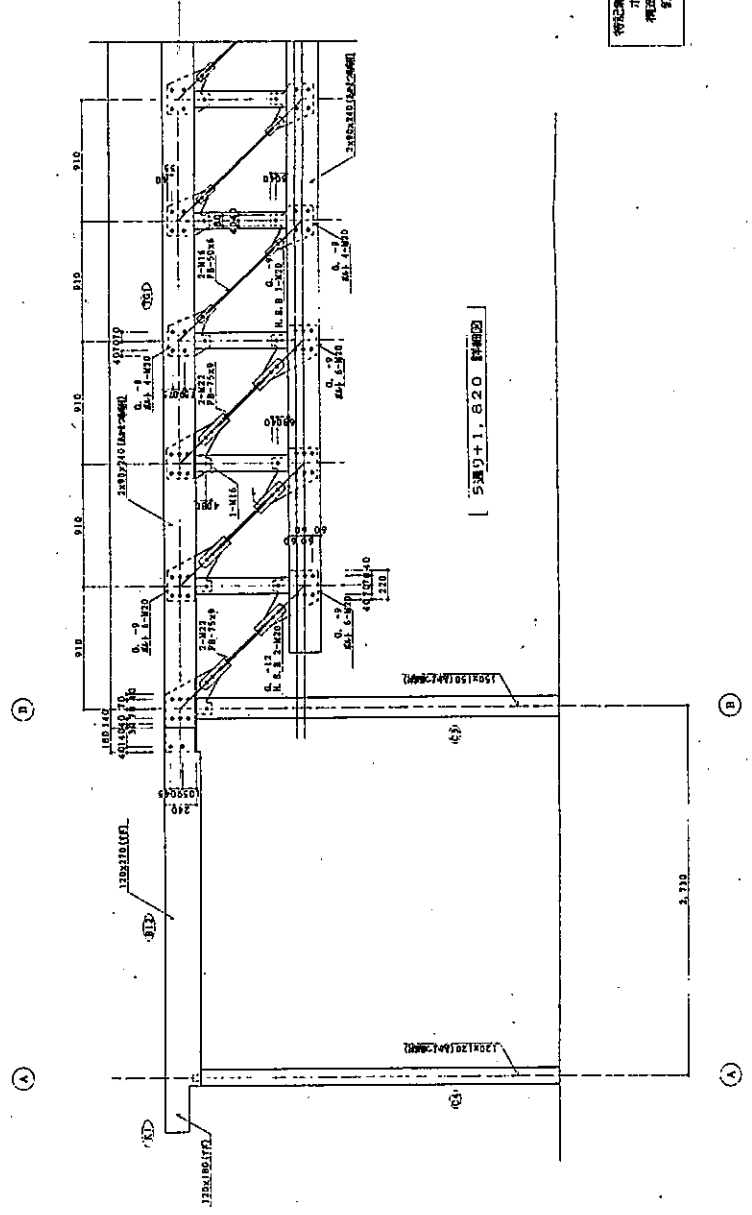
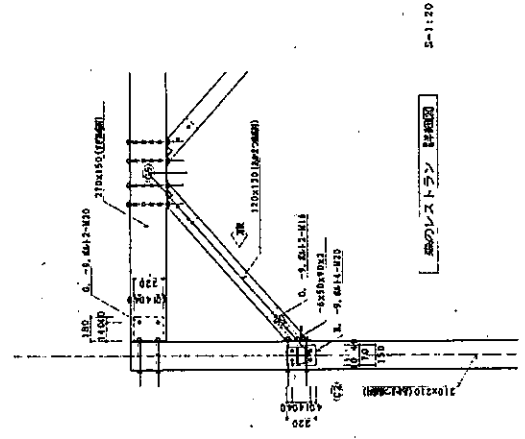
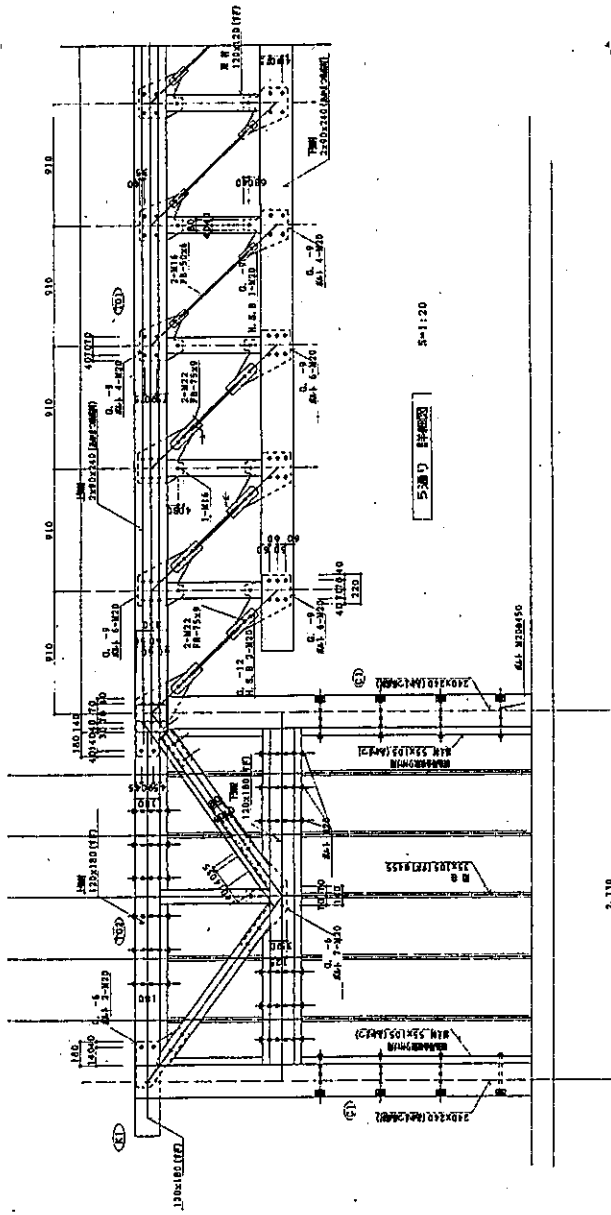

特記書き取り
 ホルト M20
 押入用全鋼製部材各部
 釘 CN65075